

Mountain Top® Style

Owner's manual

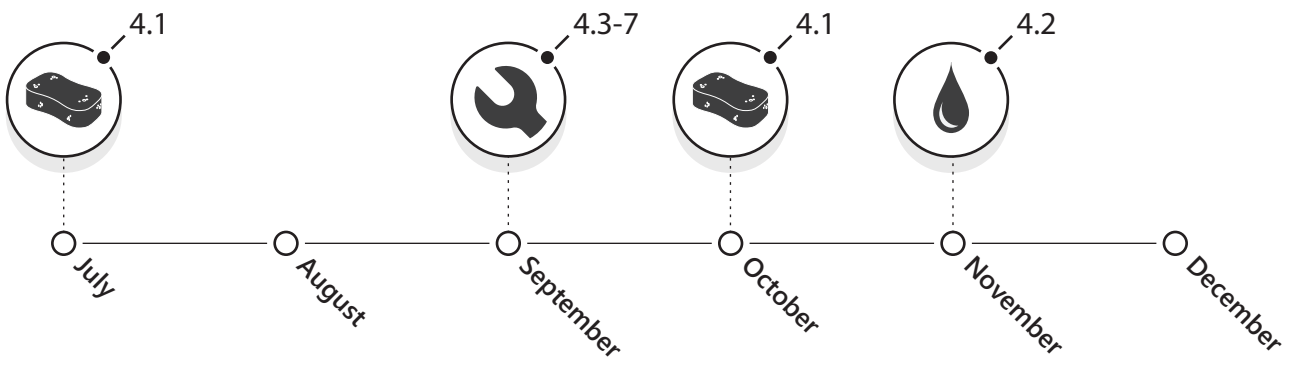

DOWNLOAD PDF

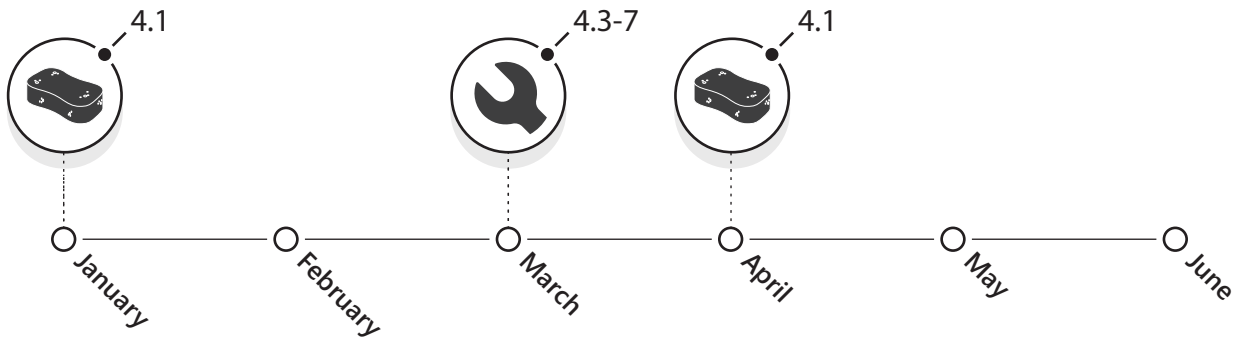

General maintenance calendar

1.	Conditions of use.....	p. 2
2.	Warnings.....	p. 4
3.	Functions.....	p. 5
4.	Maintenance	
4.1	General cleaning.....	p. 6
4.2	Lubrication.....	p. 7
4.3	Adjusting the locks.....	p. 8
4.4	Adjusting the rear clamps.....	p. 12
4.5	Adjusting the locking pins.....	p. 14
4.6	Adjusting the deflection brackets.....	p. 15
4.7	Tightening the clamps.....	p. 17
5.	Accessories.....	p. 18

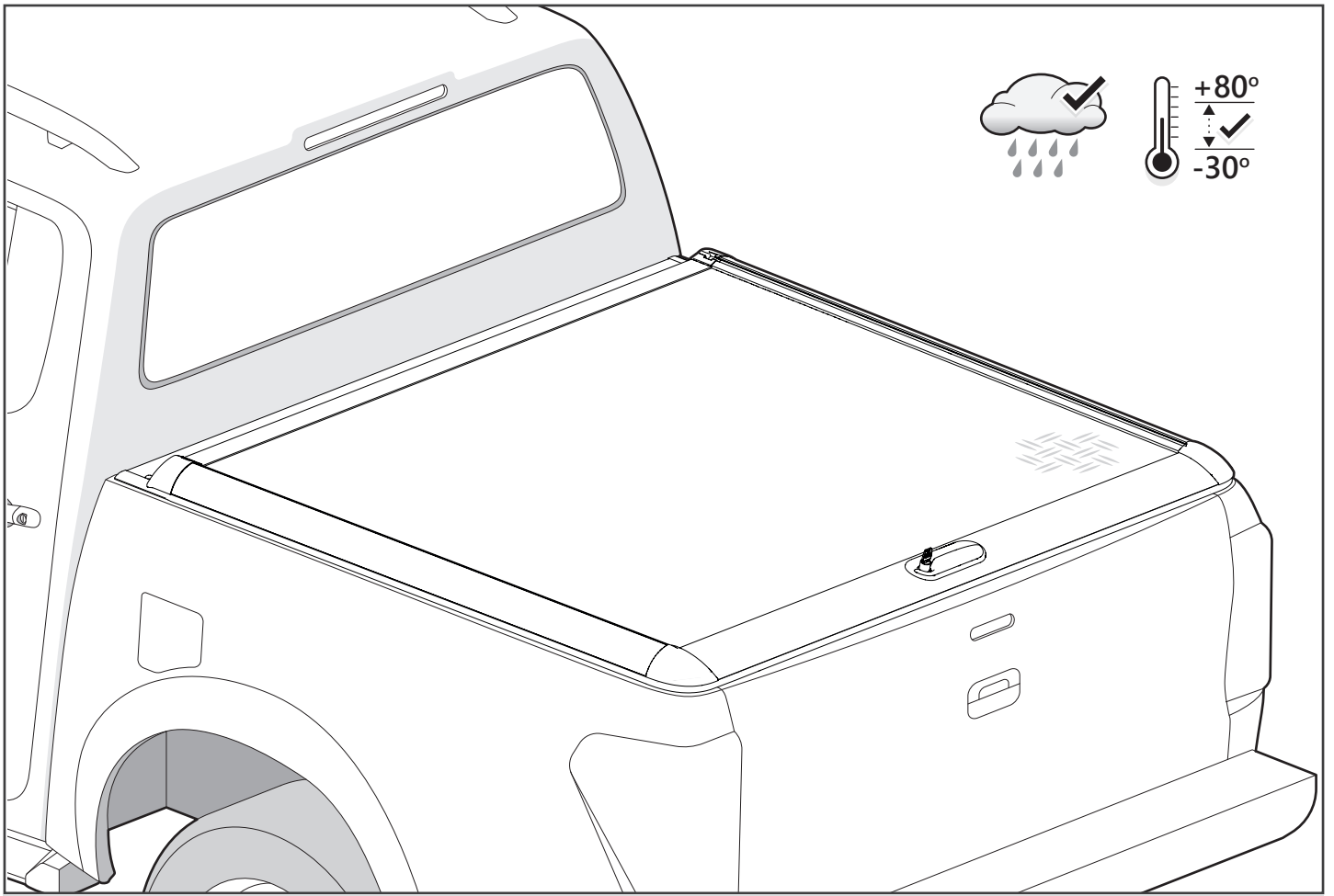

1 Conditions of use

- The Mountain Top Style cover is made of aluminium, plastics, and rubber.
- To ensure a smooth and trouble free operation, it's advised to follow this manual.
- The Mountain Top Style has been designed for normal driving conditions on roads; the design is lightweight and not suitable for extreme usage.
- Temperature range: -30 to +80 degrees Celsius.
- The purpose of the Mountain Top Style is to cover the bed from rain and dirt:
 - Designed to withstand rain water, some water ingress may occur. In the tailgate area there will be water ingress due to lack of sealing.
 - Dust can enter the compartment through various gaps around the tailgate area, other sealings etc.
- The Mountain Top Style is made of aluminium profiles which heats up and cools down relatively quick according to weather conditions. This can cause condensation on the inside of the profiles and the panels.

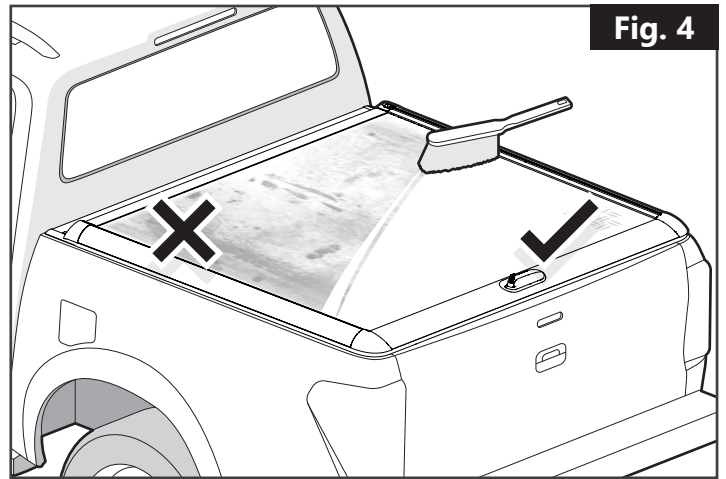
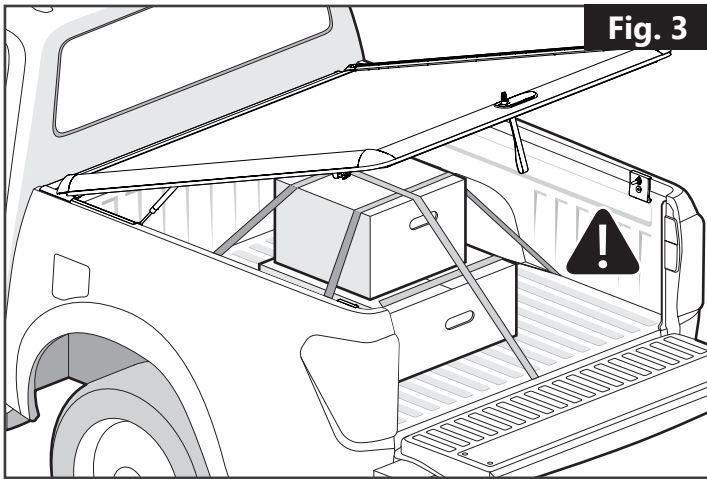
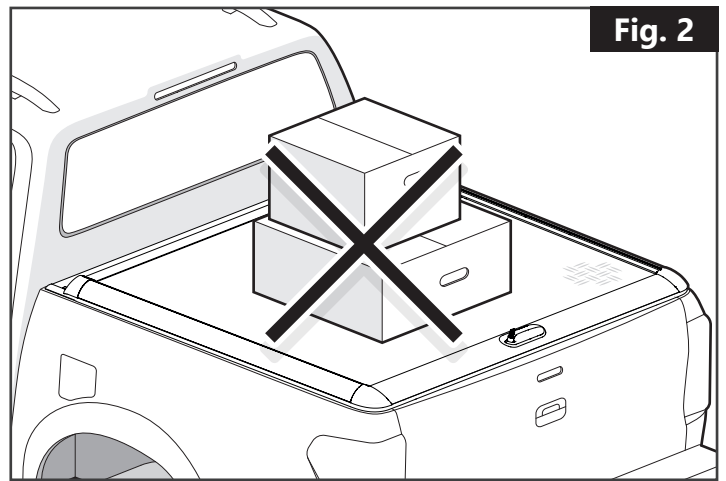
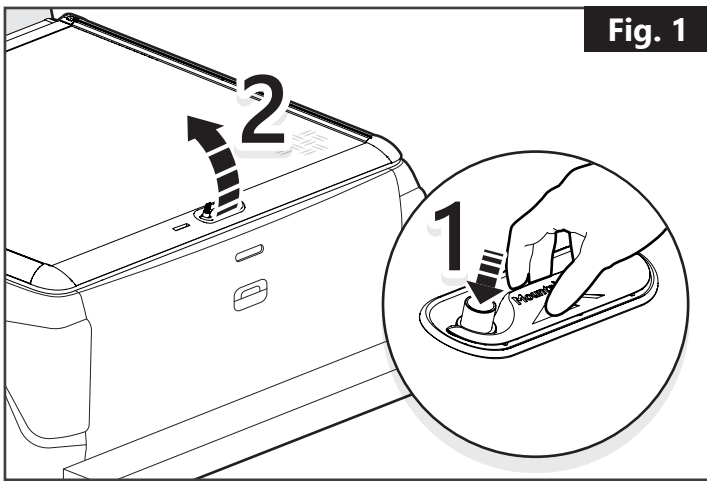

- To open the Mountain Top Style, make sure the cover is unlocked, then press the lock cylinder down, and pull the handle upwards. **(Fig. 1)**
- When closing the Mountain Top Style, you should hear 2 clicks from both locking mechanisms. If you do not hear 2 clicks, press down on the cover to properly secure the locks.
- Mountain Top Style models without handrails are not designed for cargo loading, although it can support normal snow loads. No part of it can support any load from cargo or persons and the product might be damaged if somebody stands on it. **(Fig. 2)**
- The Mountain Top Style is NOT a 100% waterproof product, but offers good protection against the elements. It is weather resistant, meaning that some water penetration is acceptable.
- Goods in the bed must be secured during transportation to prevent damage on the structural parts of the Mountain Top Style. **(Fig. 3)**
- If the Mountain Top Style is closed and has water, snow, ice or dirt on the cover, it might enter into the bed as the cover retracts. To avoid this, clean off the top surface of the cover prior to opening. **(Fig. 4)**
- The Mountain Top Style is not designed to maintain it's open position when any load is applied, except for the Cargo Carrier accessory.

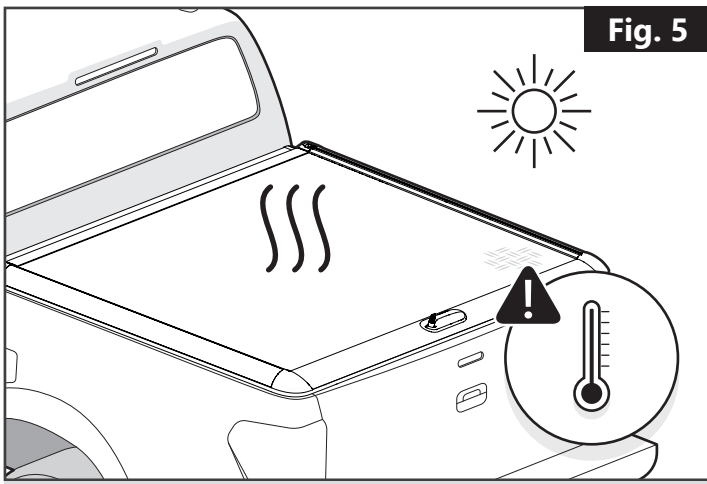

Fig. 5

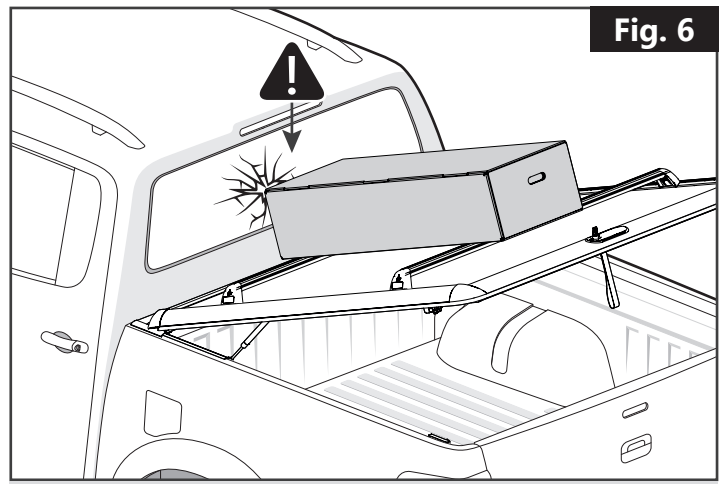

Fig. 6

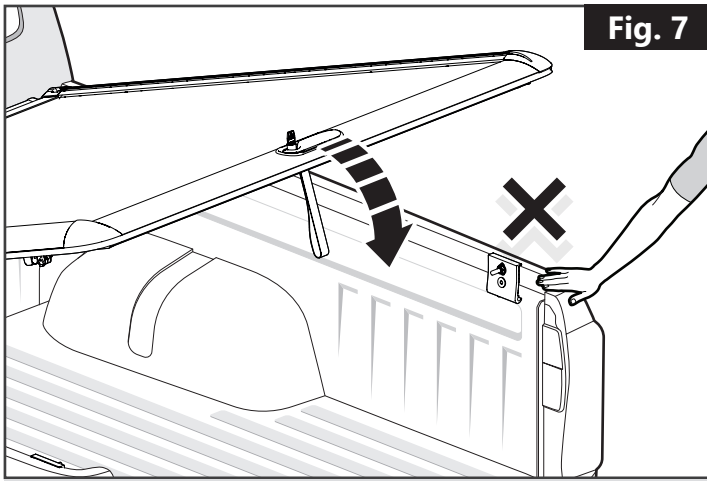

Fig. 7

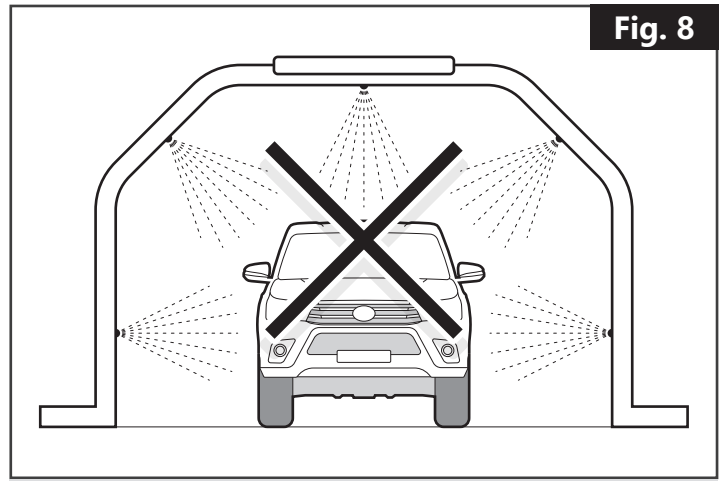

Fig. 8

2 Warnings

- Do not drive with persons under the Mountain Top Style.
 - Do not allow persons or animals to stay in the bed when the cover is closed.
 - Temperatures can be very high under the cover when closed. **(Fig. 5)**
 - Remove all top loaded cargo before opening the cover, as it may damage the truck cab. **(Fig. 6)**
 - Remove fingers from truck bed when closing the cover. **(Fig. 7)**
 - Wash the Roll cover regularly using normal car shampoo and a soft, lint free cloth or brush.
 - We do not recommend washing the Mountain Top Style in a brushless carwash, as the coating may be damaged due to use of chemicals. If washed in any carwash, or if any chemicals are used on the roll cover, please ensure a max PH value of 8 is used. **(Fig. 8)**
- To ensure a proper seal between the truck bed and the cover, always close the tailgate
- before closing the cover.

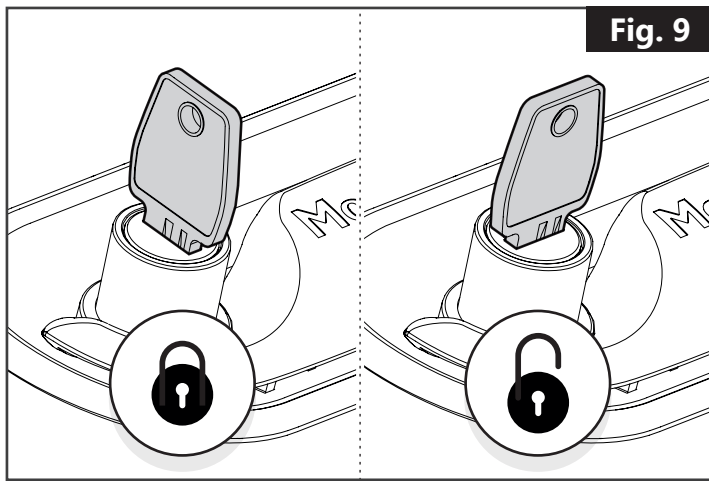

Fig. 9

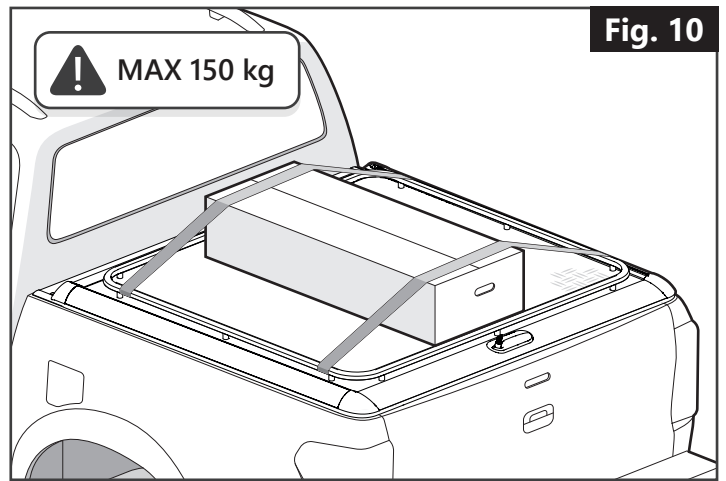

Fig. 10

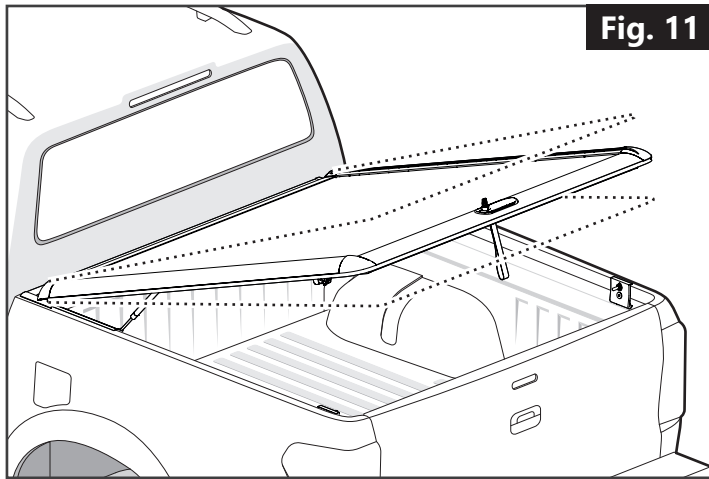

Fig. 11

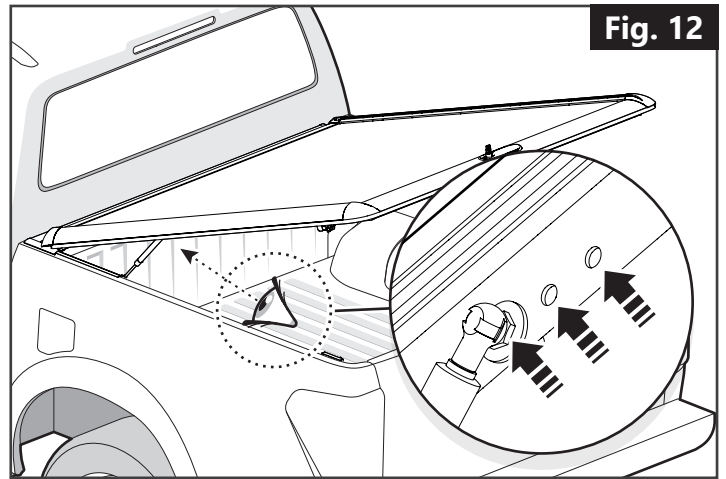

Fig. 12

3 Functions

- The Mountain Top Style can be locked or unlocked by turning the key accordingly. **(Fig. 9)**
- Mountain Top Style models with handrails fitted, can hold cargo loads up to 150 kg. **(Fig. 10)**

The fully opened position of the Mountain Top Style can be adjusted to 3 different heights **(Fig. 11)**. To adjust the height, re-position the gas springs to one of the 3 holes available. **(Fig. 12)**

- The Mountain Top Style can get small bumps and scratches when cargo is loaded directly on the checkered plate.

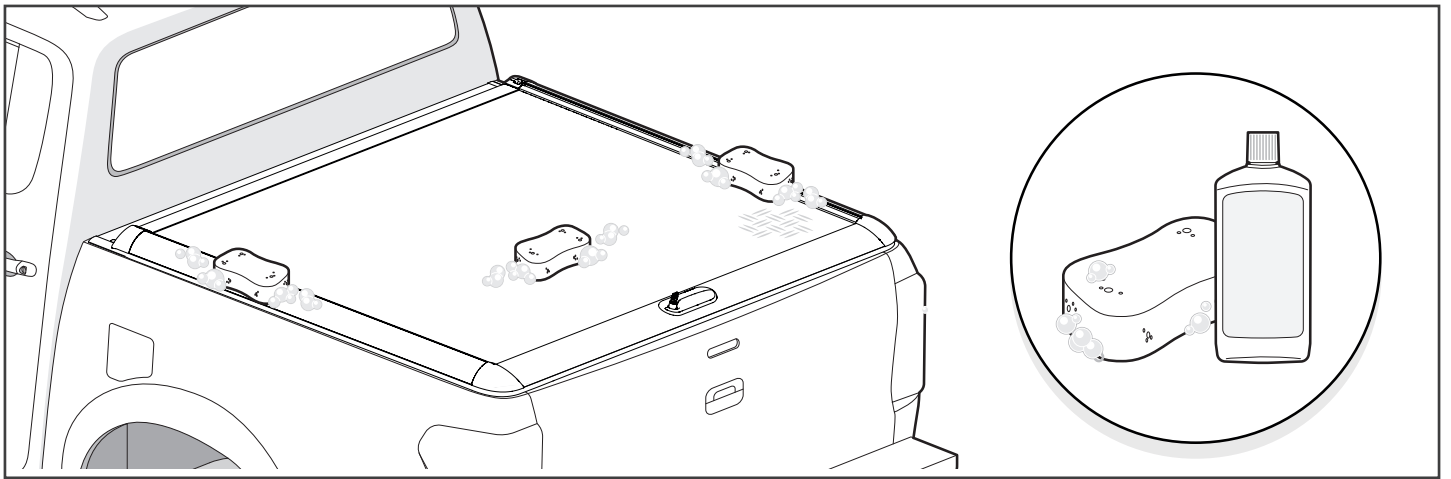
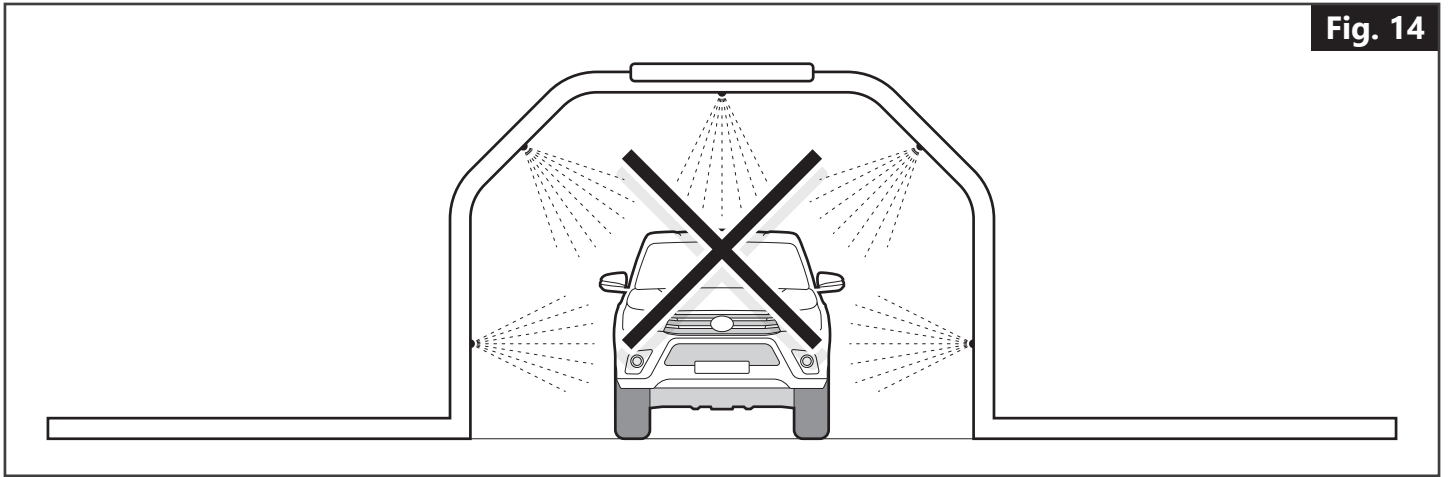

Fig. 14



4.1 General cleaning

- The Mountain Top Style should be cleaned on a regular basis using water with normal car shampoo. **(Fig. 13)**
- When cleaning, use a soft, lint free cloth or brush. Rinse soap foam off thoroughly with water, and dry with a clean cloth. It is vital that any other chemicals such as petrol, strong alkaline or acid are NOT used on the surface.
- Do not use abrasive cleaning tools such as steel wool, hard brushes, abrasive scourers, as these may damage the coating surface and change the color or gloss levels of the finish.
- We do not recommend washing the Mountain Top Style in a brushless carwash, as the coating may be damaged due to use of chemicals. If washed in any carwash, or if any chemicals are used on the roll cover, please ensure a max PH value of 8 is used. **(Fig. 14)**

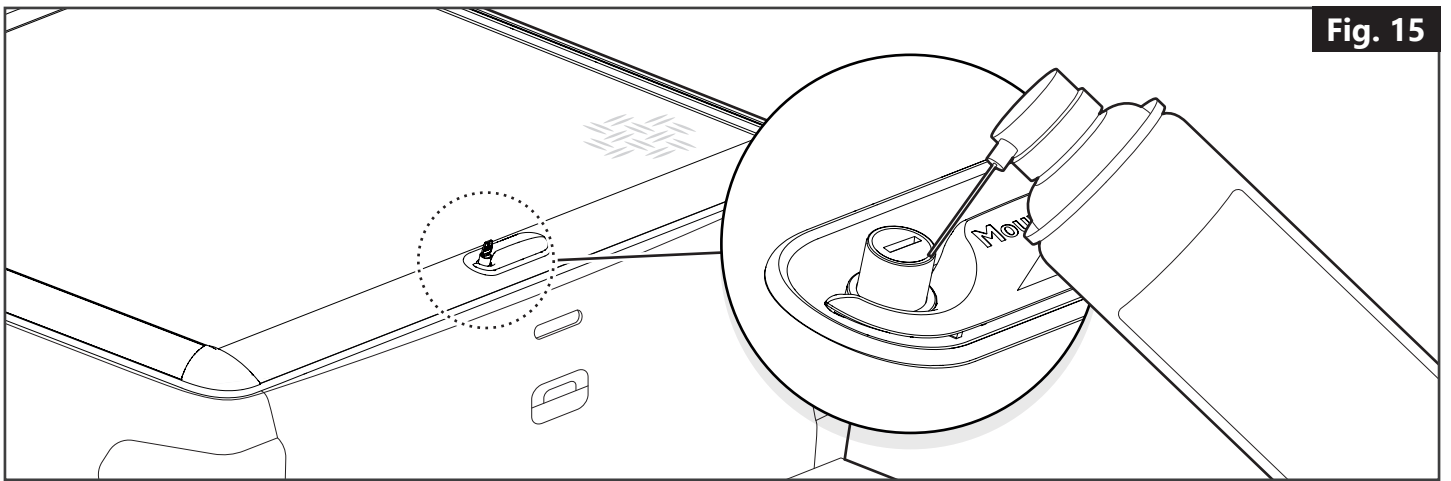

Fig. 15

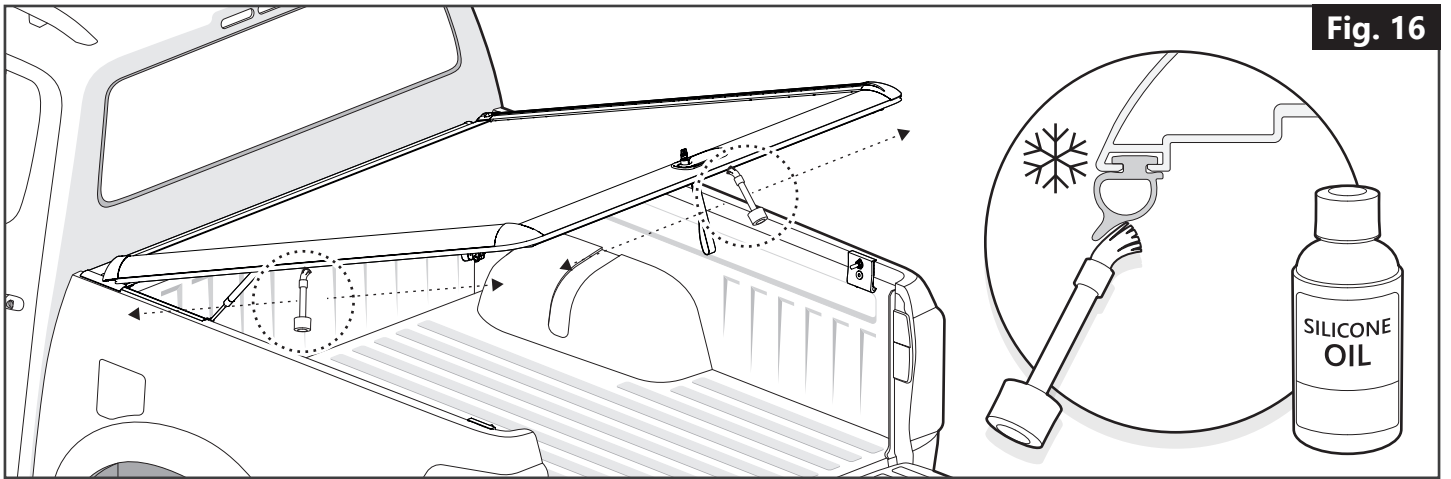
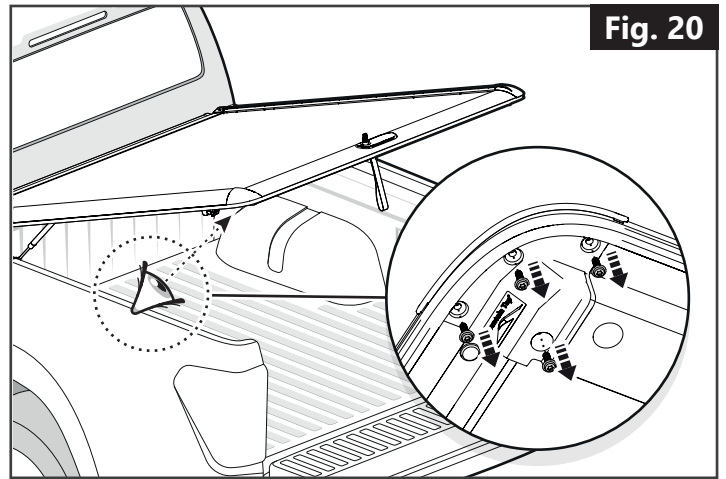
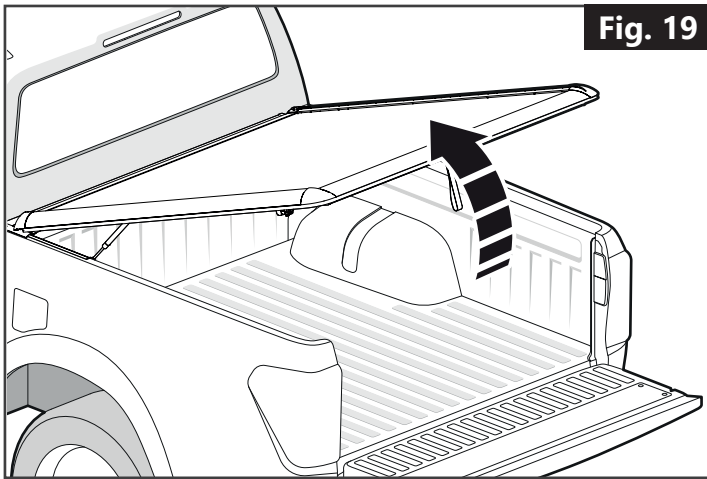
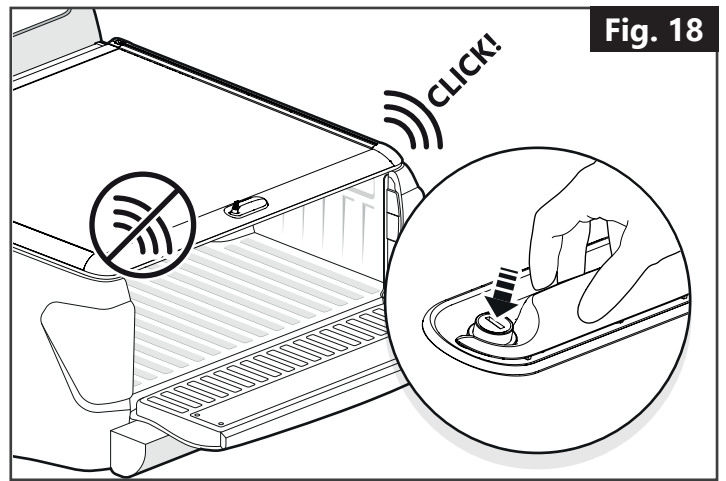
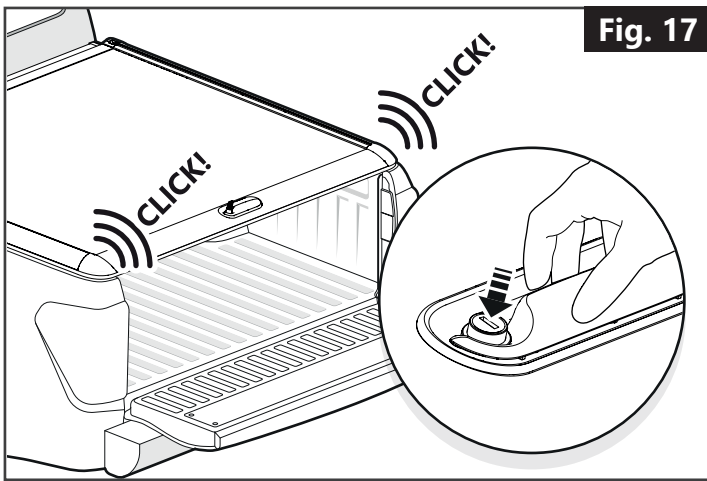

Fig. 16

4.2 Lubrication

- The lock should be lubricated regularly using a suitable lock lubricant (e.g. Würth lock spray), or similar. **(Fig. 15)**
- To prevent frost damage, the rubber seal should be cleaned and lubricated regularly using silicone oil (e.g. Würth Silicone Oil), or similar. **(Fig. 16)**



4.3 Adjusting the lock cables

- When the lock release button is pressed, both sides of the cover will unlock at the same time. (**Fig. 17**) If one side fails to unlock correctly (**Fig. 18**), the lock cable may need to be adjusted. To adjust the lock cable, follow the steps below.

- 1) Open the cover. (**Fig. 19**)
- 2) Remove the 4 screws underneath the plastic corner. (**Fig. 20**)

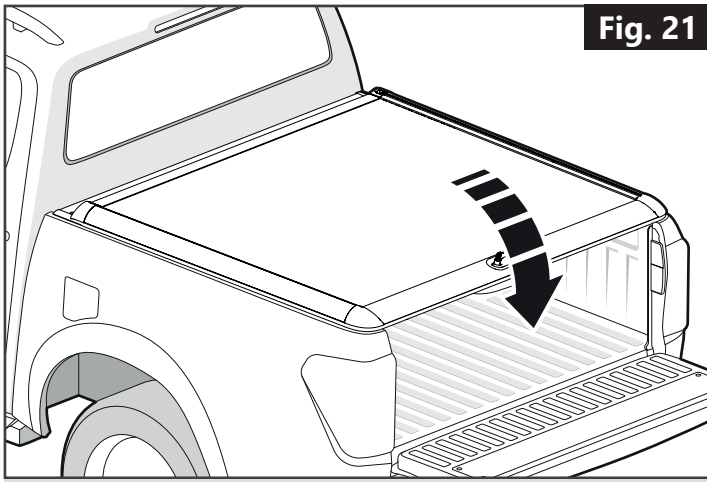

Fig. 21

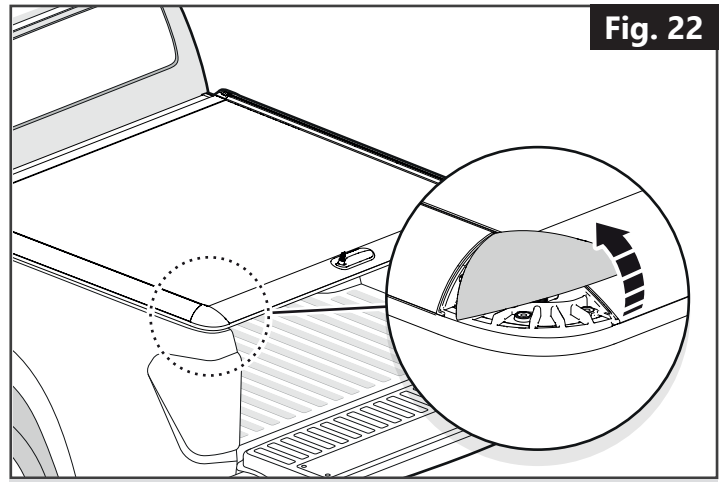

Fig. 22

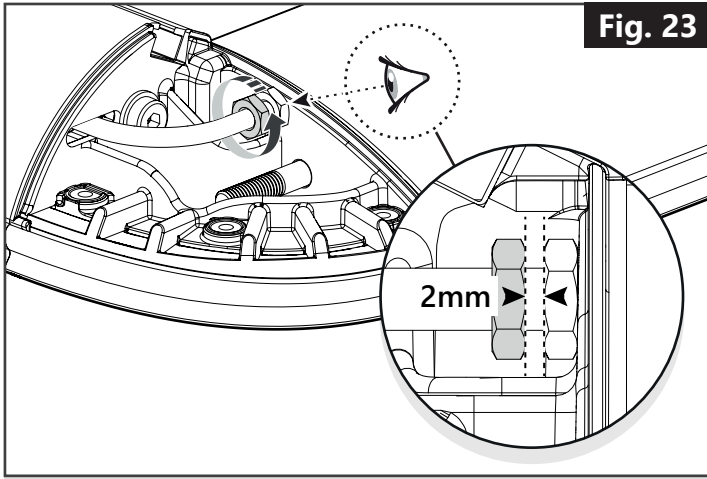

Fig. 23

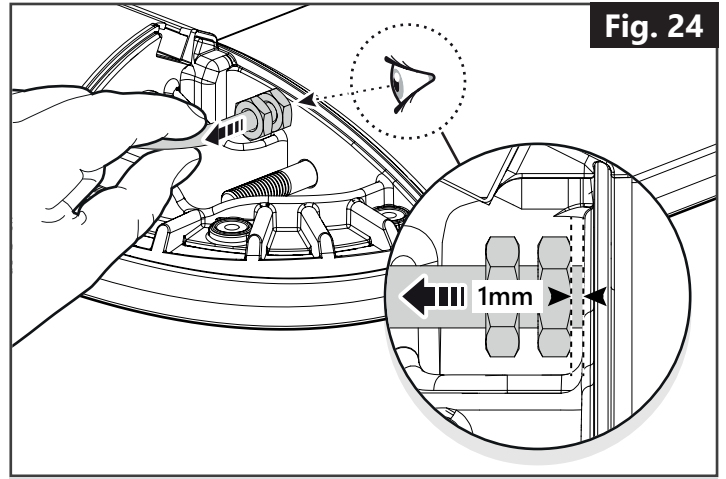

Fig. 24

- 3) Close the cover. **(Fig. 21)**
- 4) Lift the plastic cover. This may require force, as the the plastic binds with the sealing. **(Fig. 22)**
- 5) Underneath the plastic cover, locate and loosen the outer nut until there's ~2mm space between the inner and outer nuts. **(Fig. 23)**
- 6) Gently pull the cable corner assembly outwards ~1mm. **(Fig. 24)**

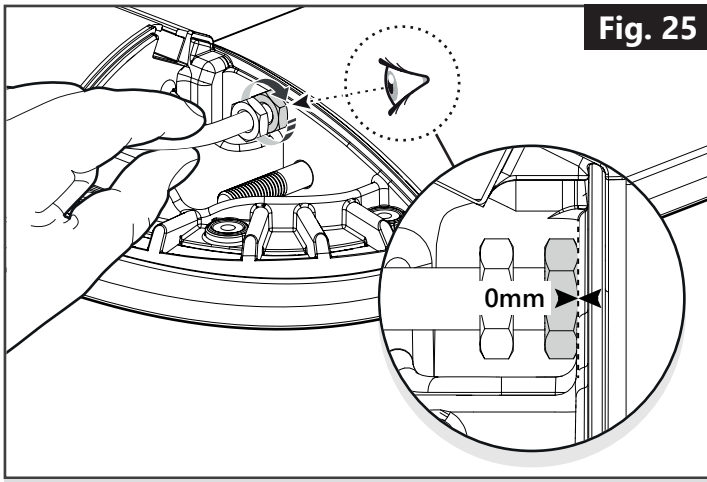

Fig. 25

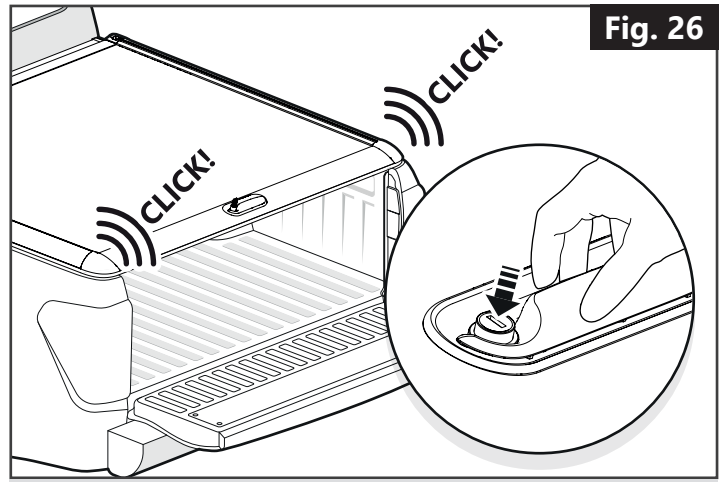

Fig. 26

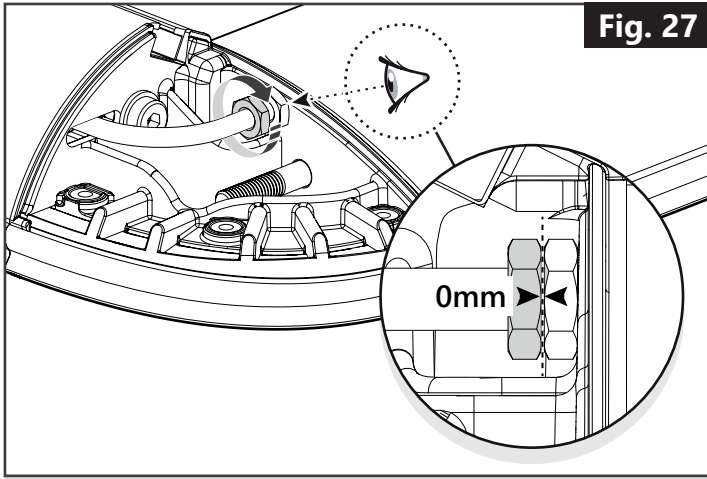

Fig. 27

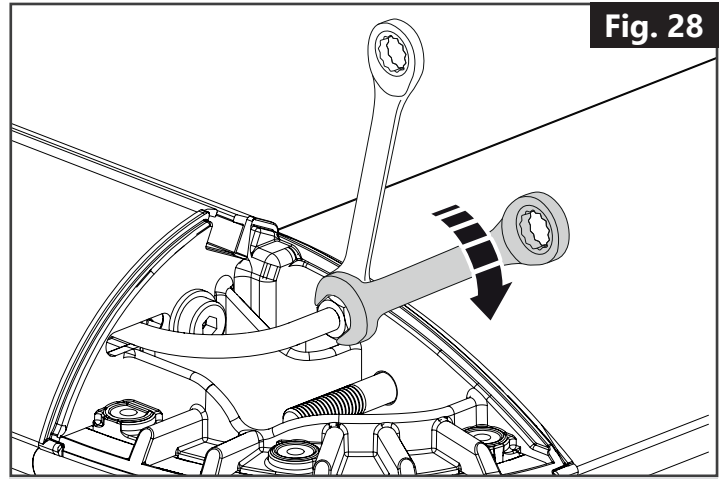
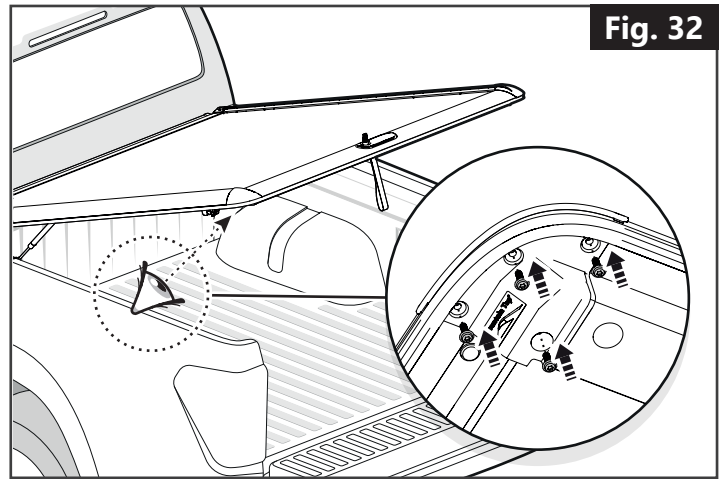
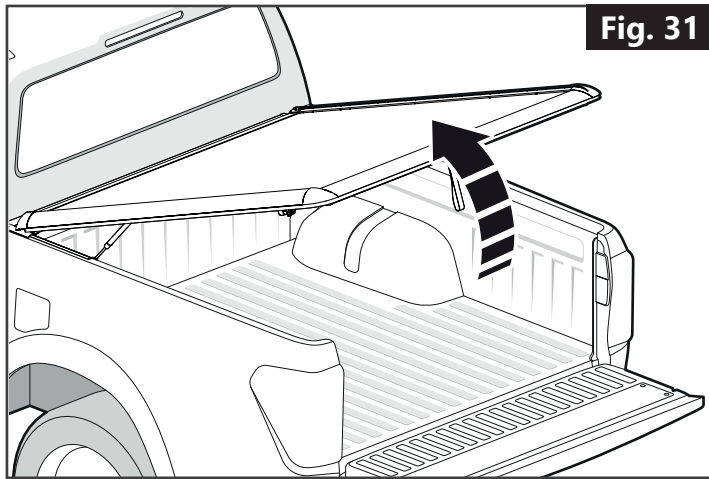
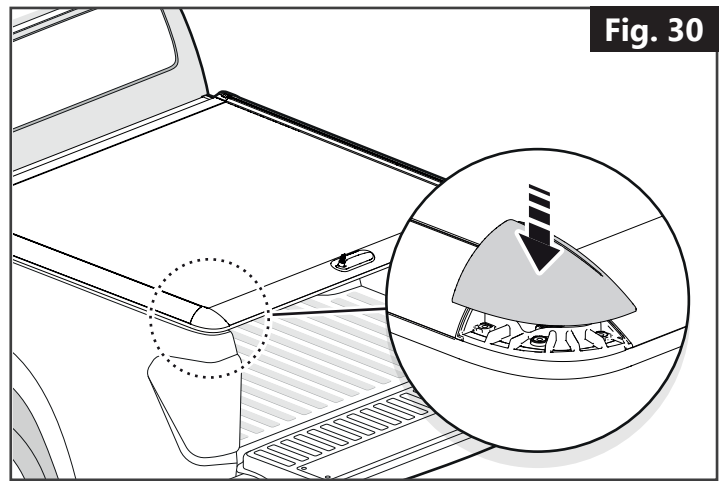
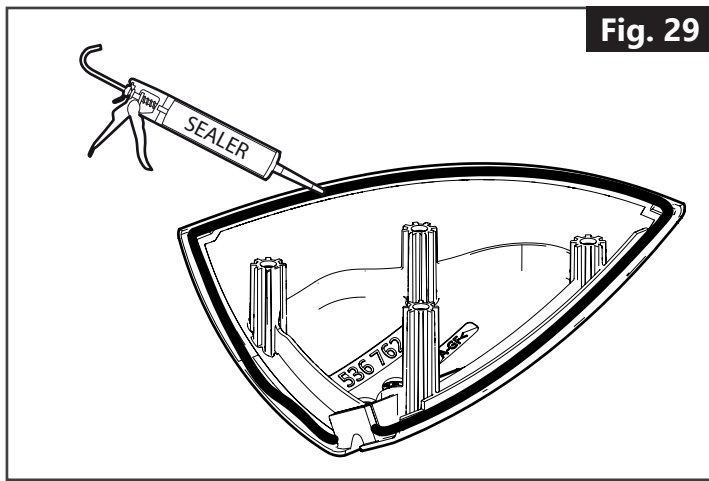

Fig. 28

- 7) While keeping the cable corner assembly in place, lightly tighten the inner nut to keep the assembly in it's new position. **(Fig. 25)**
- 8) Close the cover, and press the lock release button **(Fig. 26)**. If the cable has been positioned correctly, both sides of the cover should unlock at the same time. If not, return to **(Fig. 22)**, and adjust the lock cable again.
- 9) Lightly tighten the outer nut, so it sits flush with the inner nut. **(Fig. 27)**
- 10) Using 2 10mm wrenches, keep the inner nut in place, while tightening the outer nut. **(Fig. 28)**



11) Re-apply fresh sealer around the inner edge of the plastic cover. **(Fig. 29)**

12) Re-attach the plastic cover in it's original place. **(Fig. 30)**

13) Open the cover. **(Fig. 31)**

14) Insert the 4 screws, and tighten the using a torque wrench to 1,2Nm. **(Fig. 32)**

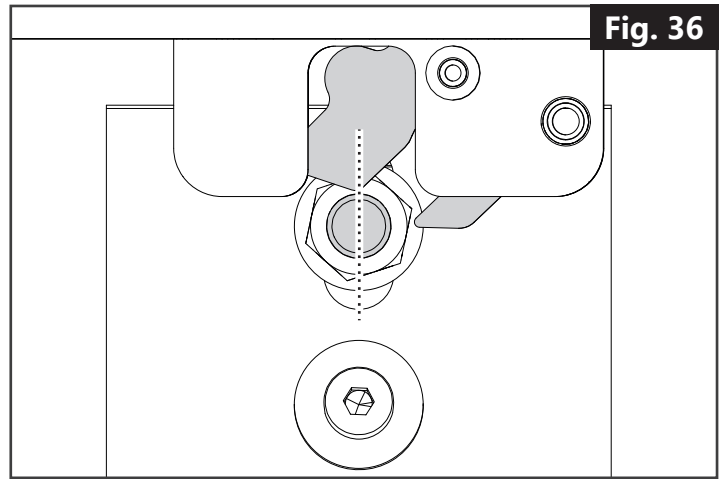
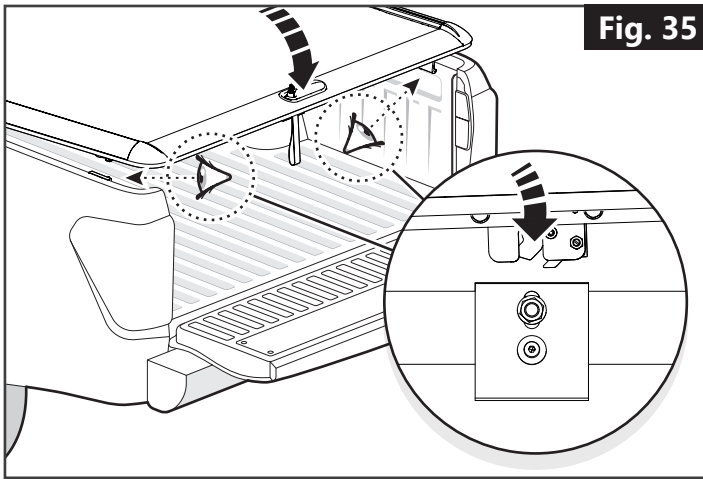
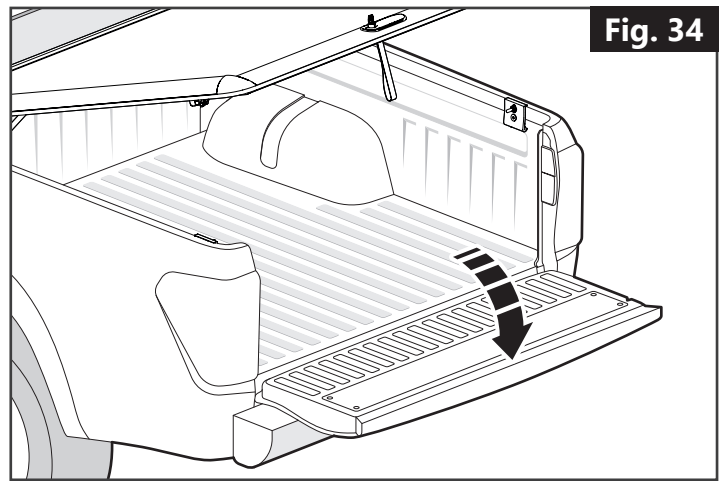
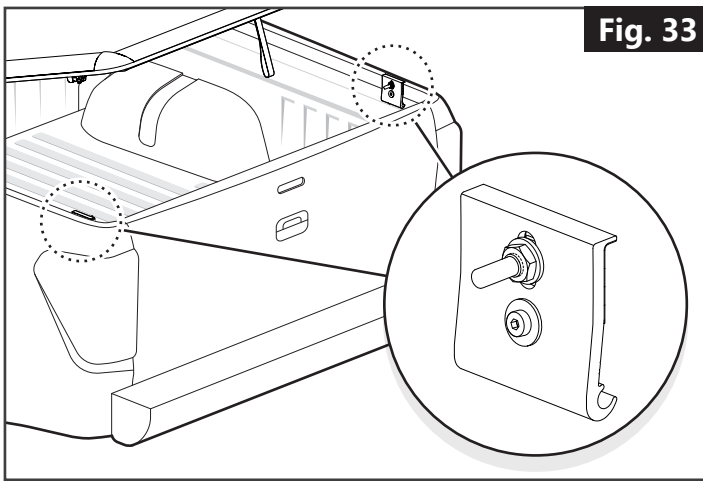

4.4 Adjusting the rear clamps

- Regularly check the positioning of the rear clamps. If the clamps are not positioned correctly, the locking mechanism may not operate correctly. **(Fig. 33)** Check the rear clamp position by following the steps below.
 - 1) Open the tailgate. **(Fig. 34)**
 - 2) Lower the cover, and position it so the lock is resting on the locking pins. **(Fig. 35)**
 - 3) If the rear clamps are positioned correctly, the locking pins should be in the center of the lock. **(Fig. 36)**

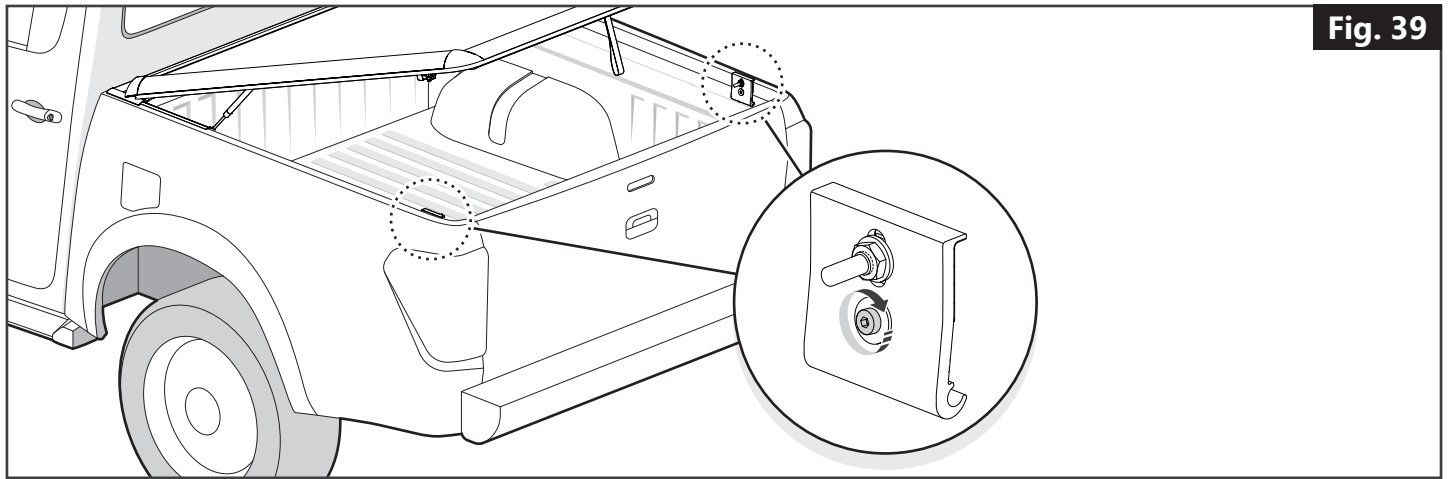
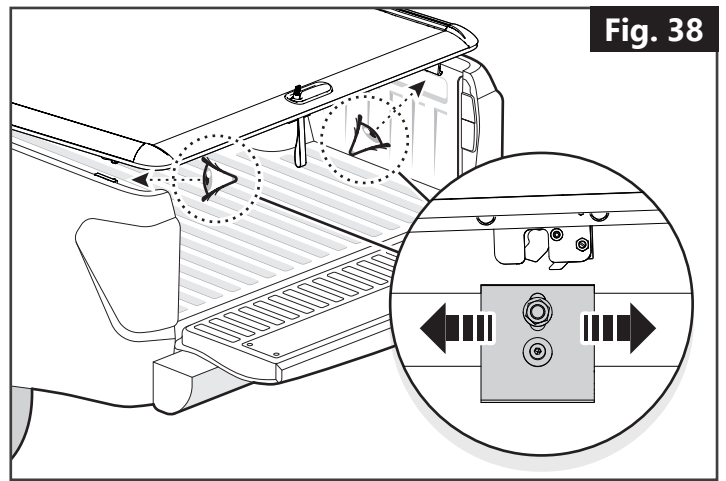
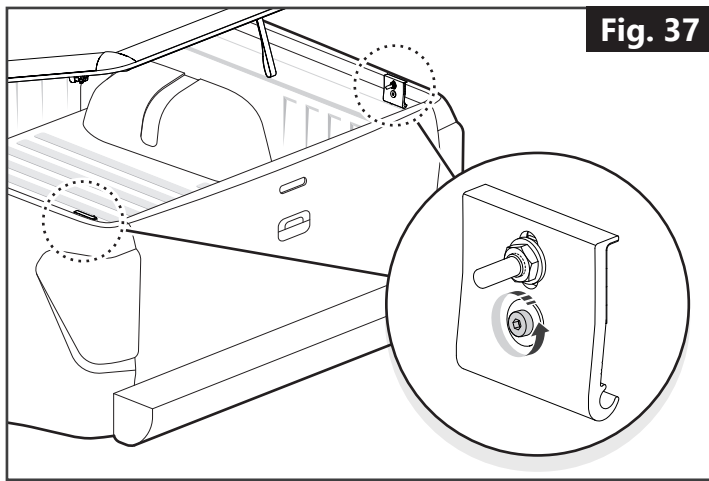

- 4) If the locking pin is not in the center of the lock, first loosen the clamp (**Fig. 37**), and then re-position the clamp correctly. (**Fig. 38**)
- 5) When the clamps are positioned correctly, tighten the clamp again using a torque wrench to 8 Nm. (**Fig. 39**)

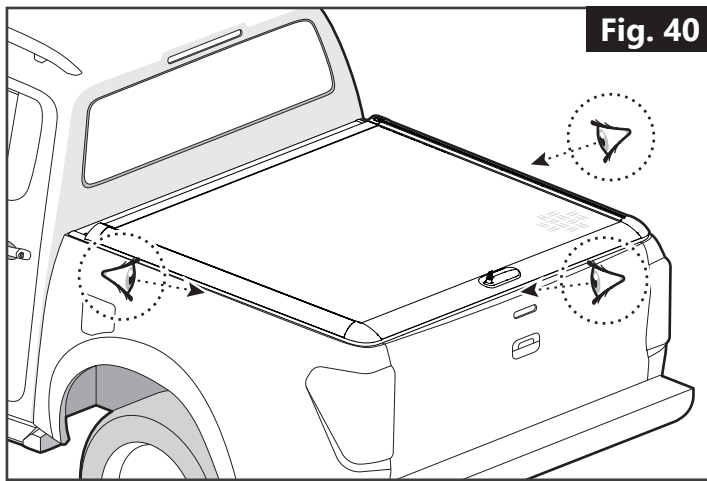

Fig. 40

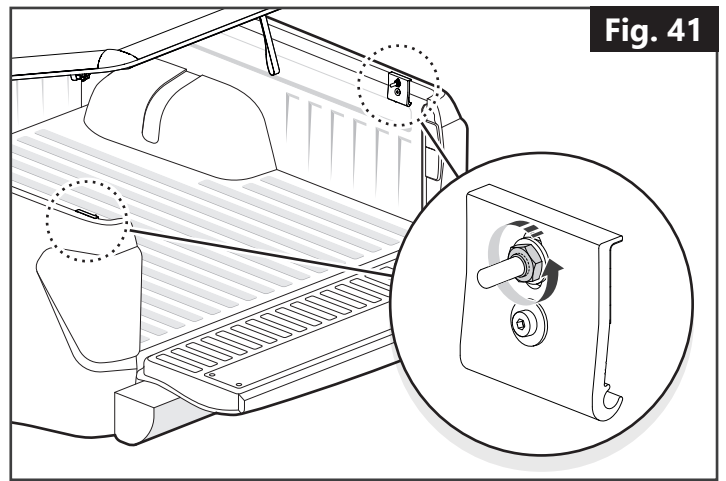

Fig. 41

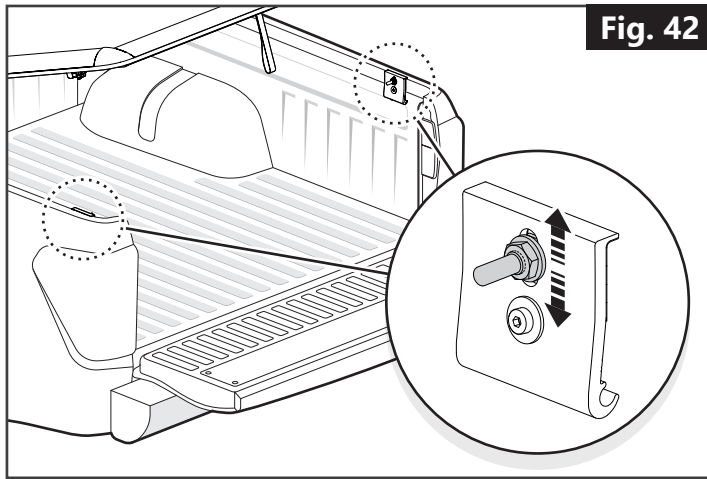

Fig. 42

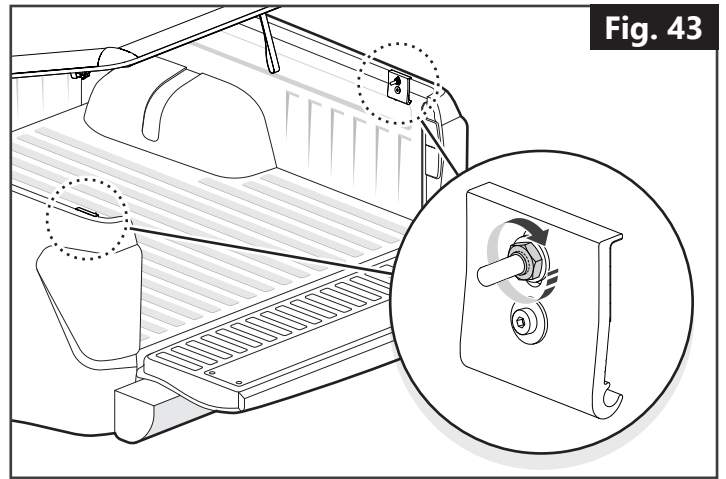
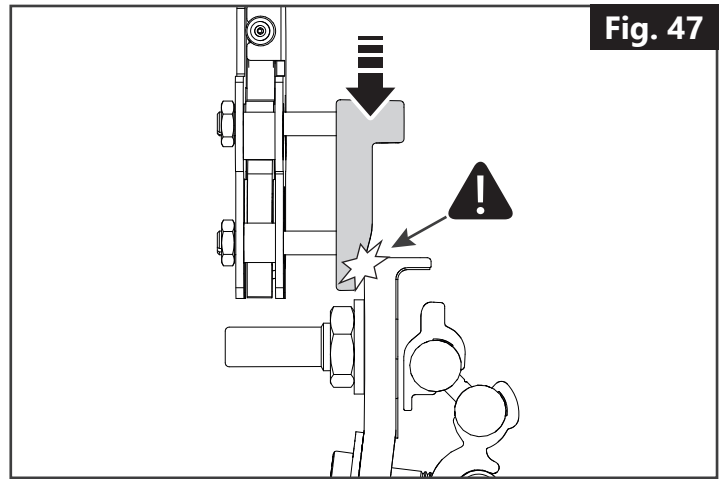
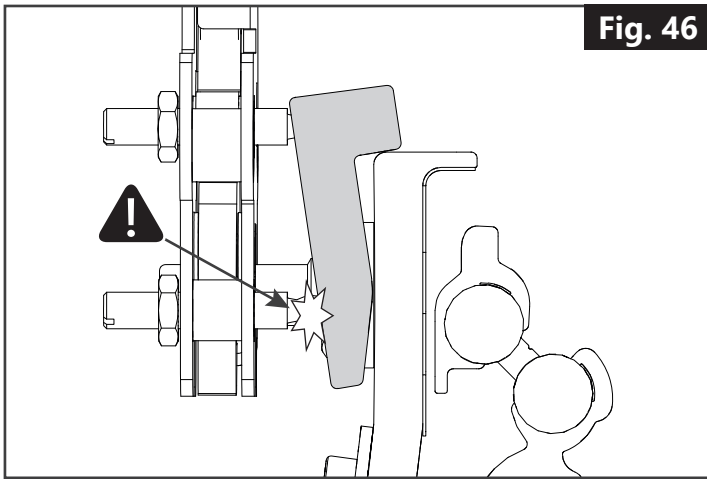
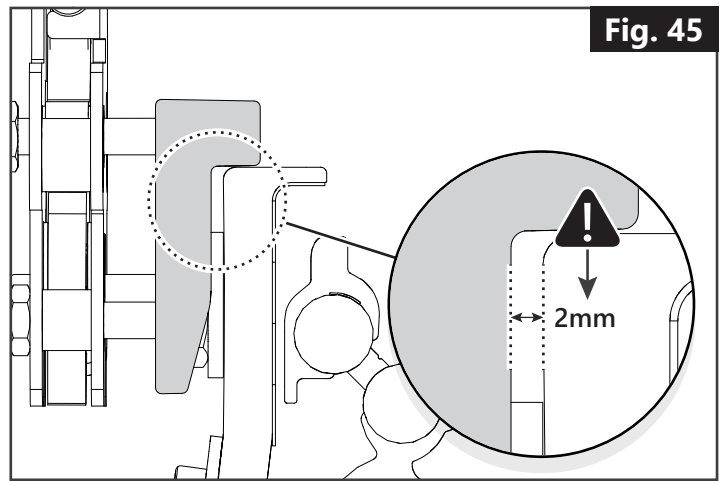
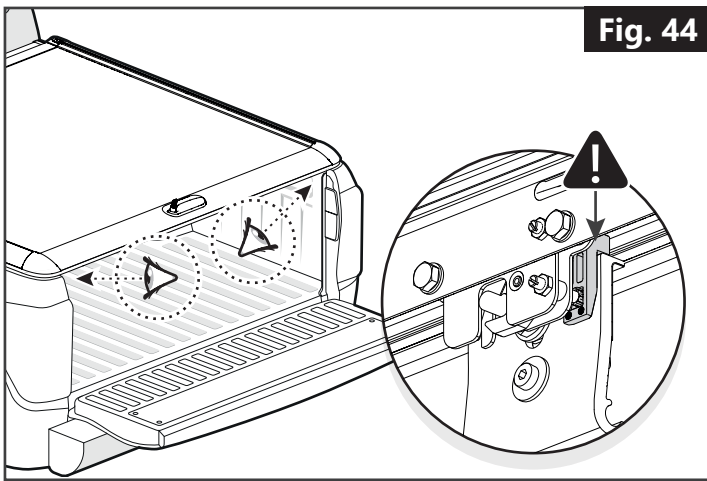

Fig. 43

4.5 Adjusting the locking pins

- If the rubber seal around the cover does not sit correctly on the edge of the truck bed (**Fig. 40**), or if the cover is hard to fully close, the locking pins may not be positioned correctly.
 - If there are any gaps between the rubber seal and the edge of the truck bed, the locking pins may be set too high, and need to be lowered.
 - If the cover is hard to fully close, the locking pins may be set too low, and need to be raised.
- 1) To re-position the locking pins, first open the cover, and loosen the locking pins. (**Fig. 41**)
 - 2) Re-position the locking pin. (**Fig. 42**)
 - 3) Re-tighten the locking pin using a torque wrench to 20 Nm. (**Fig. 43**)



4.6 Adjusting the deflection brackets

- Regularly check the distance between the deflection brackets and the rear clamps. (Fig. 44)
- The correct distance must be 2mm. (Fig. 45)
- If the distance is more than 2mm, the deflection bracket may twist and break off when the cover is closed. (Fig. 46)
- If the distance is less than 2mm, the cover can't close properly, and the deflection bracket may break. (Fig. 47)

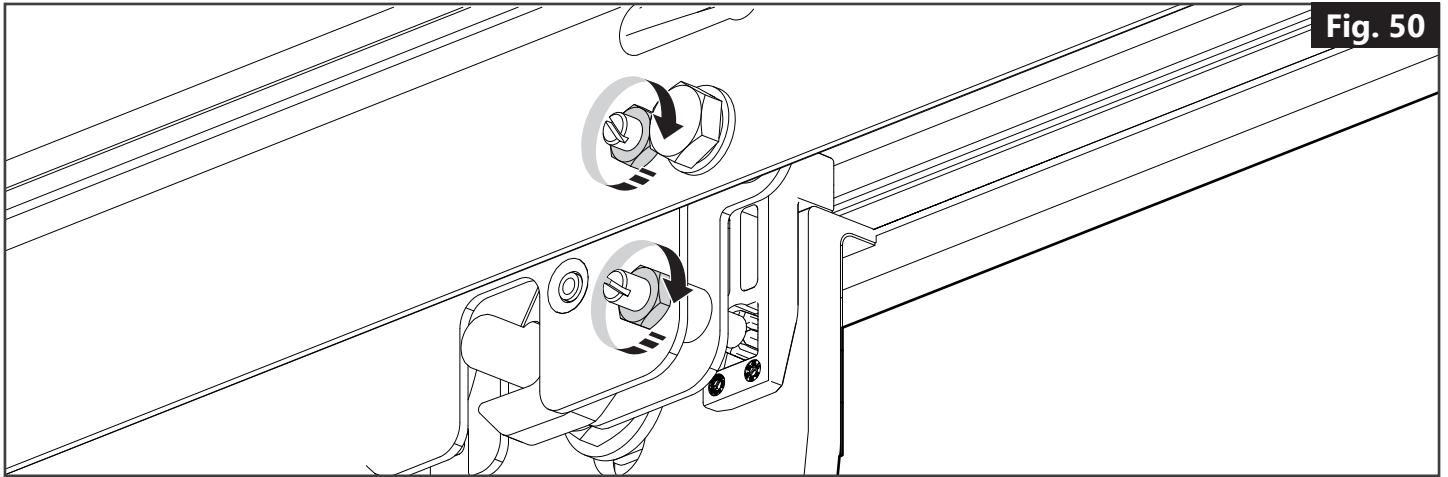
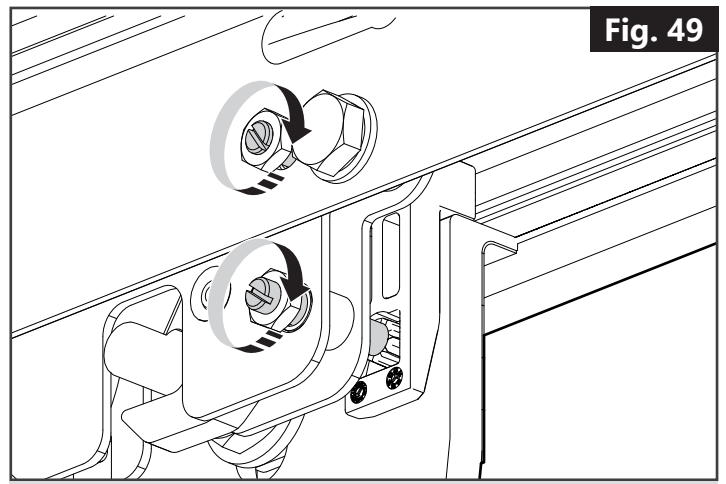
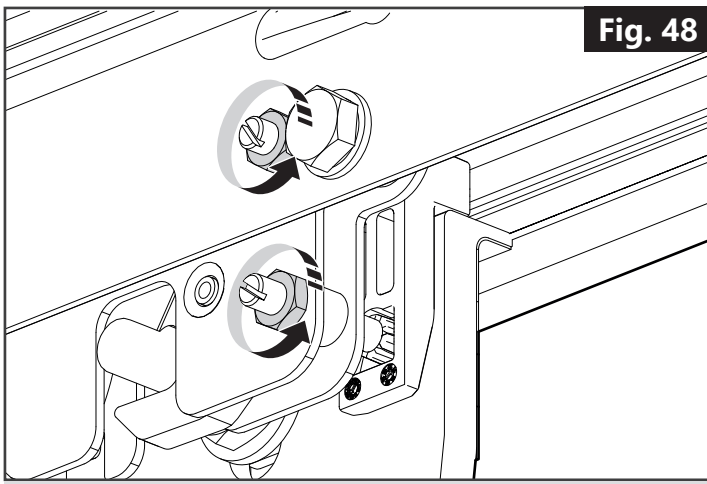

- 1) Re-position the deflection bracket by first loosening the locking nuts. **(Fig. 48)**
- 2) Turn the pins using a flat head screwdriver to position the deflection bracket. Turn clockwise to decrease the distance to the rear clamps, or turn anti-clockwise to increase the distance to the rear clamps. **(Fig. 49)**
- 3) Lock the deflection bracking in place by re-tightening the locking nuts. **(Fig. 50)**

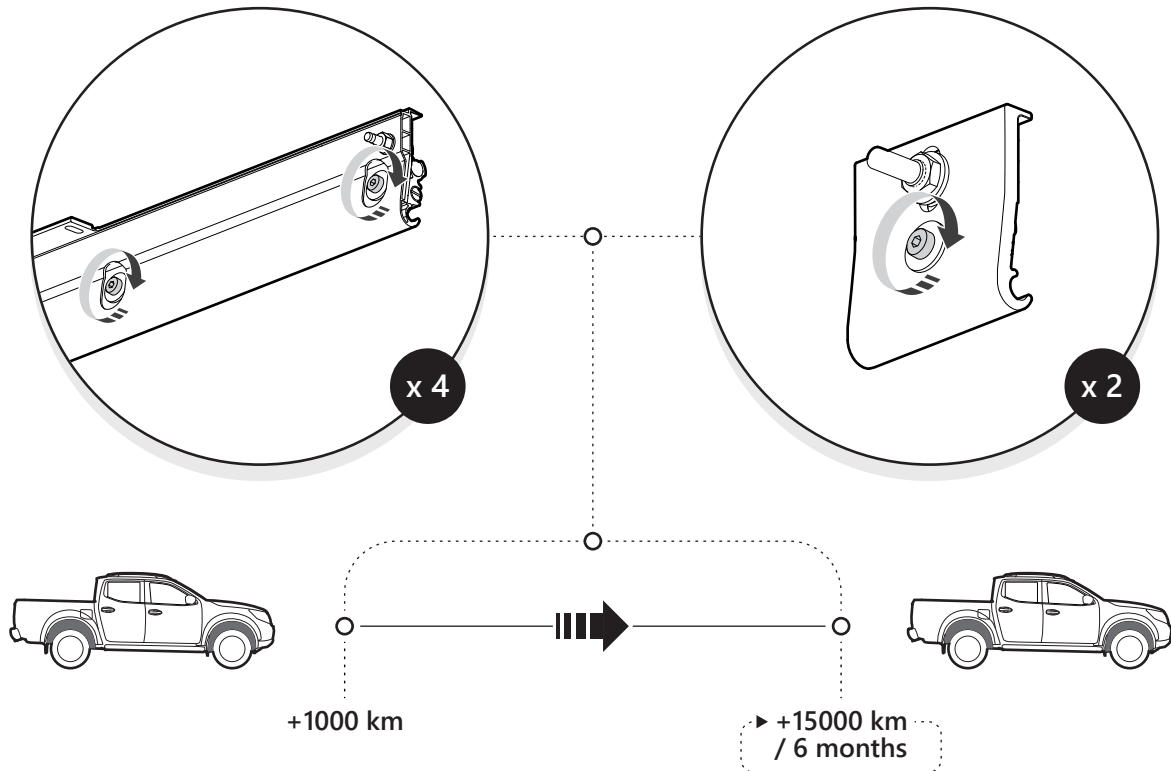

4.7 Tightening the clamps

- The clamps should be positioned correctly, and re-tightened to 8 Nm. (**Fig. 51**) at these intervals :
 - 1000 km after first use.
 - After every 15.000 km (recurring) or every 6 months.

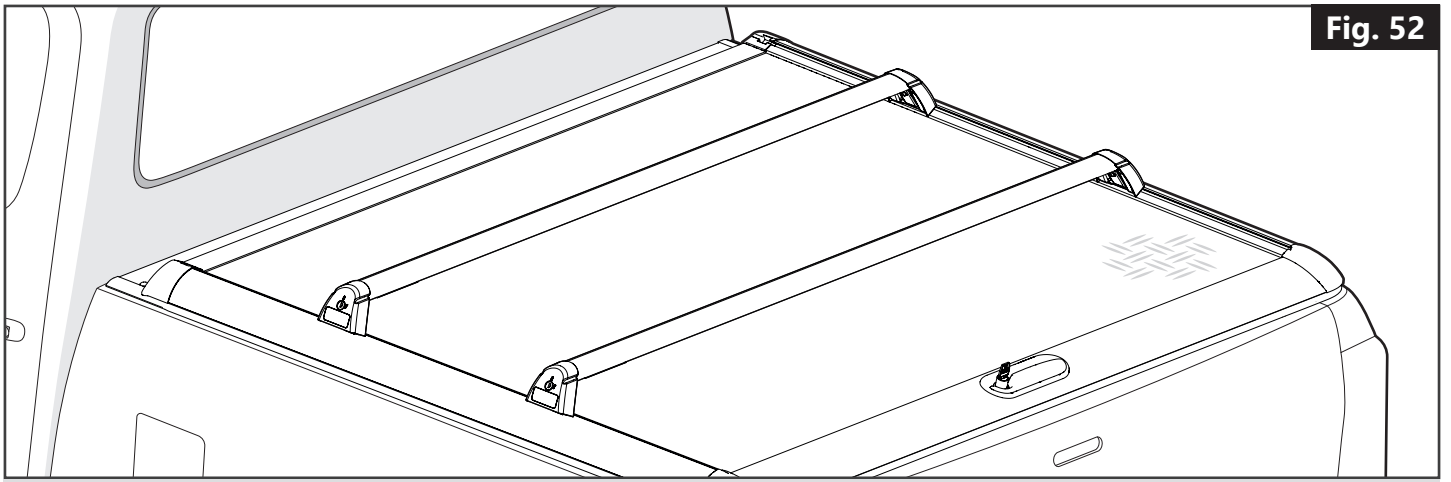

Fig. 52

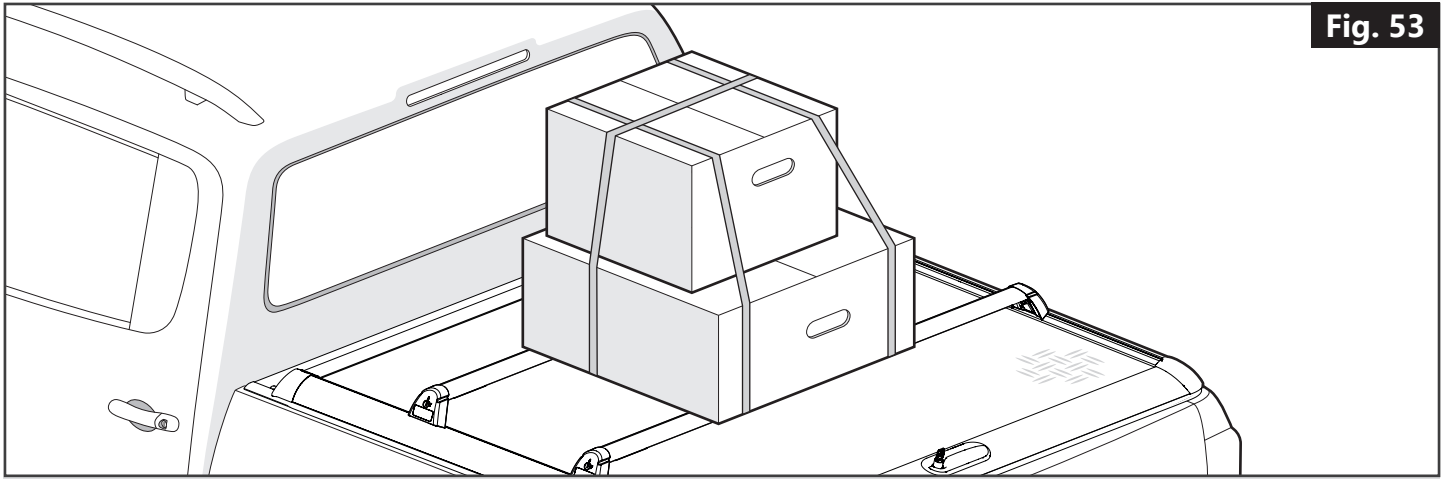

Fig. 53

5 Accessories

- Mountain Top Cargo Carrier. (*Fig. 52*)
 - Combined load capacity of 75 Kg (including bars) (*Fig. 53*)
 - Lockable end-caps
 - Moveable



Customer Service	+45 4810 2950 (08:00 - 16:00 CET)
Fax	+45 4810 2960
Support	info@mountaintop.dk
Website	www.mountaintop.dk
Address	Pedersholmparken 10, 3600 Frederikssund, Denmark